



T-Edge

Quick Start Guide



REQUIRED SAFETY CAUTIONS

IMPORTANT: Read the safety section in the T-Edge operation manual prior to operating T-Edge



CAUTION: Hot surface.



CAUTION: It is recommended that a ground fault circuit breaker (GFCI) be installed on the power outlet

NOTE:

Refer to the T-Edge manual before operating the device/autoclave

T-EDGE OVERVIEW

T-Edge is a fully automatic tabletop autoclave designed for sterilization of equipment used in first aid rooms, hospitals, dental clinics and medical clinics. It provides the following benefits:

- Strict compliance with international safety standards
- Clinically proven sterilization capabilities
- Optimal chamber capacity with convenient equipment loading
- High-resolution tactile touchpad with a user friendly interface

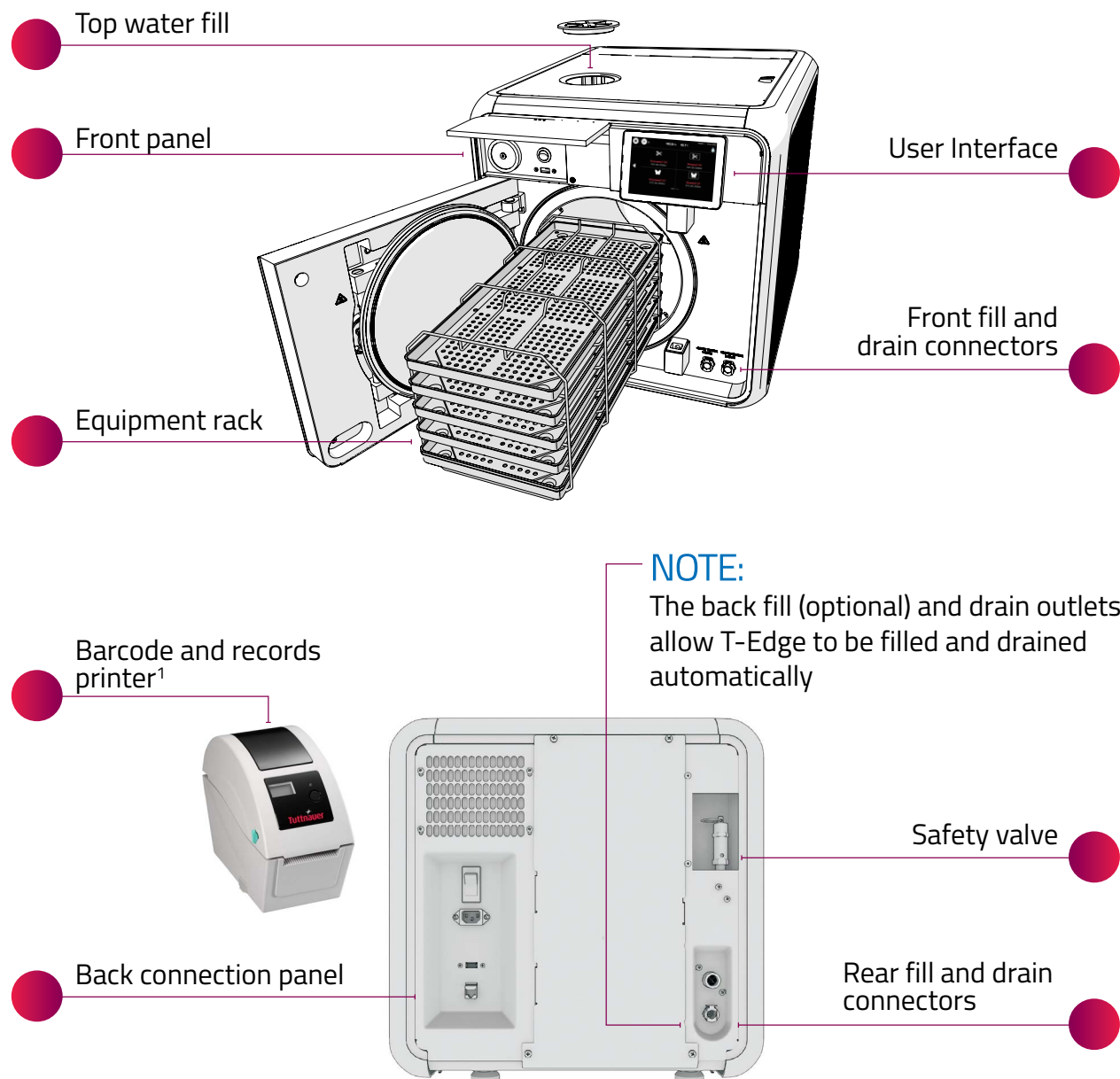

¹ Optional equipment is supplied based on specific customers order

CONNECTING T-EDGE

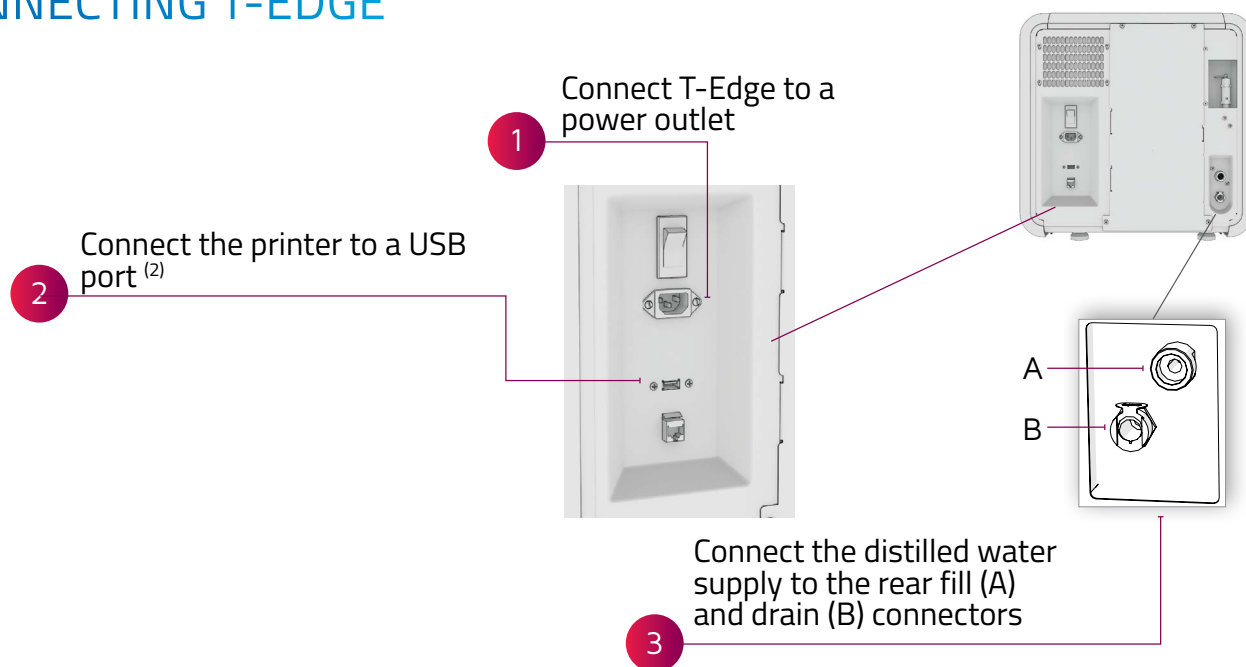

POWERING UP T-EDGE

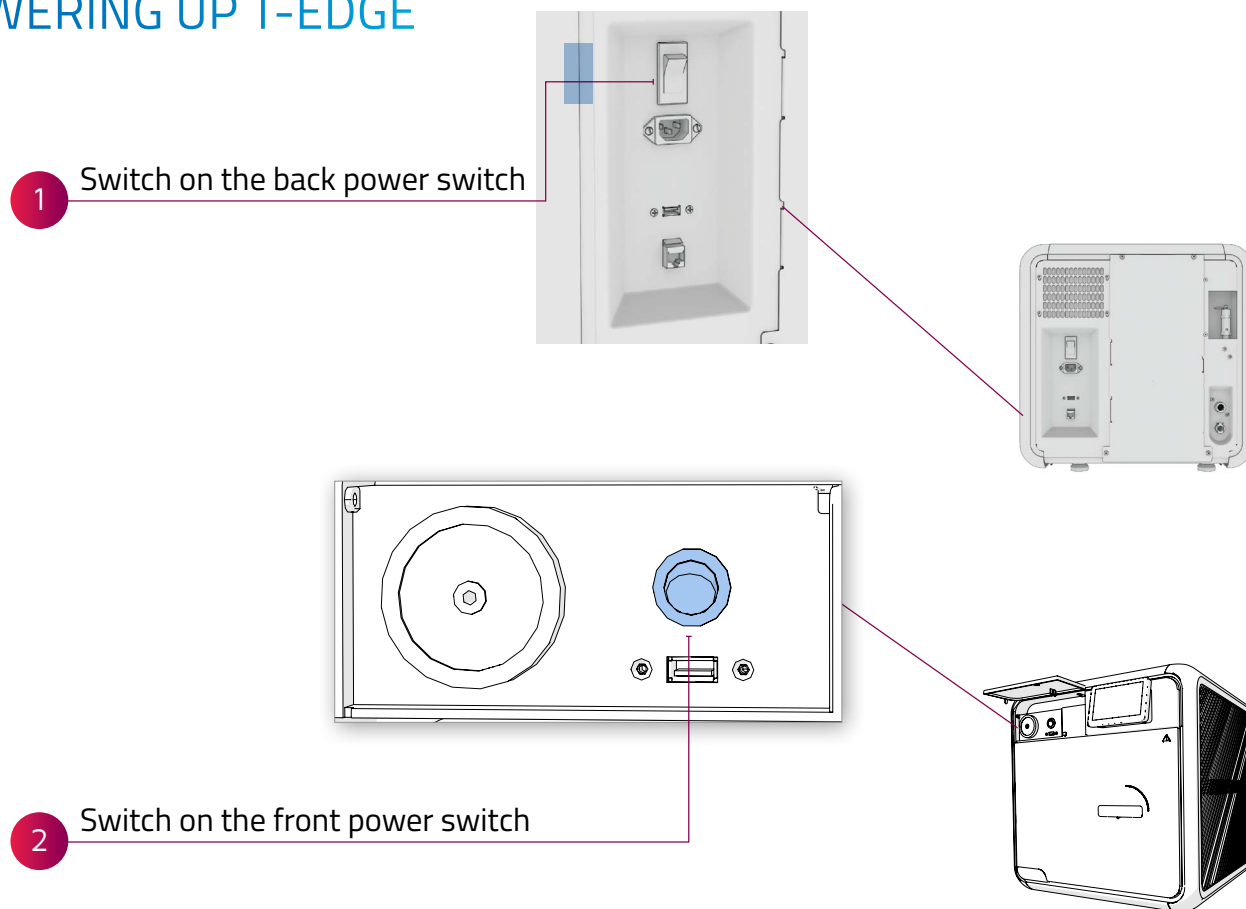

² Use of these ports and connectors is optional

INITIAL DATE AND LANGUAGE SETUP

When T-Edge powers on for the first time, perform the following steps:

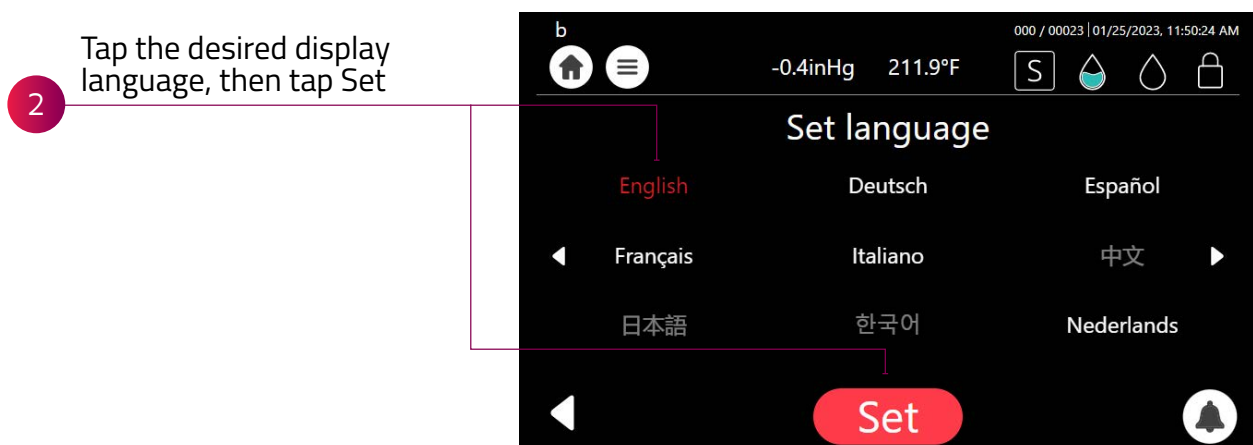
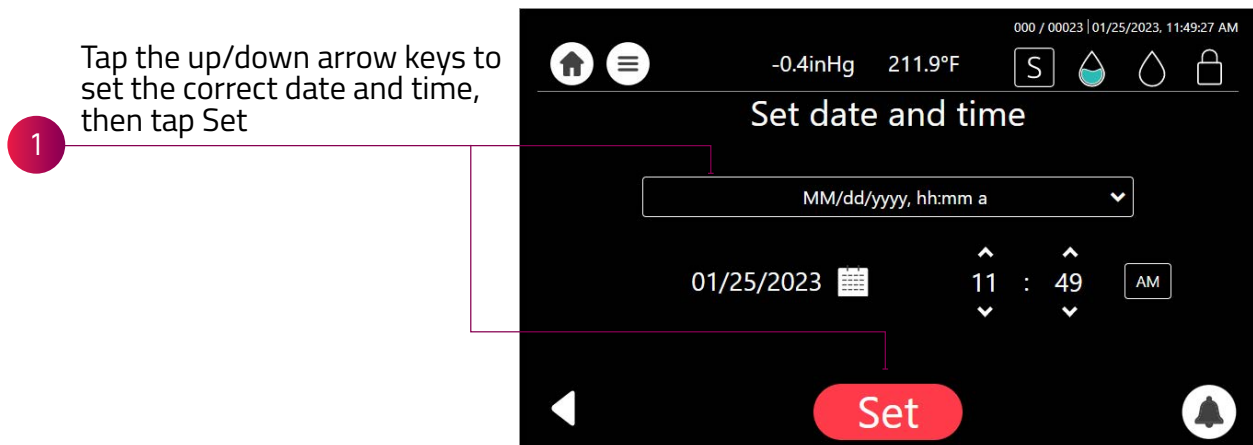

WI-FI CONFIGURATION

Prior to operating the autoclave for the first time, please connect the Wi-Fi and ensure it remains connected at all times.

The Wi-Fi connection is used for uploading all data information from devices in the field, to the online company's server.



This data is used for:

- Monitoring
- Viewing and downloading device history
- Software updates while validating the integrity of the update (applicable for users with Tuttnauer code)

The data is backed-up on the device main board.

Note: In case of connection failure, the data may be exported manually.

To connect the Wi-Fi:

1. In the **Quick Option** screen, press the **Wifi Configuration** option .
2. To enable the connection, press .
3. The **Wifi Configuration** screen is displayed with the available networks.

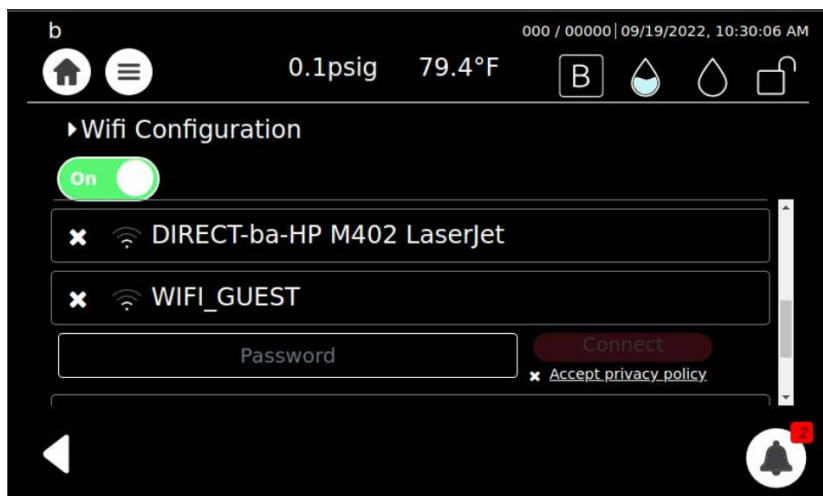

4. Select your network, enter your Password and press the Accept privacy policy.

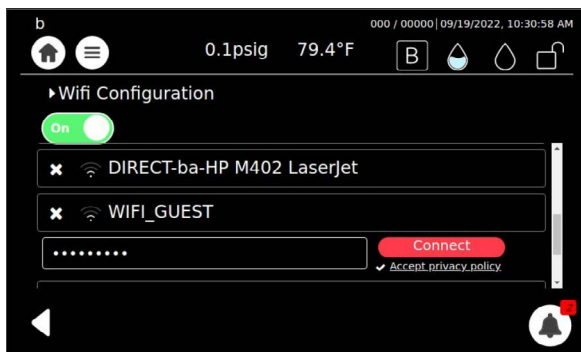
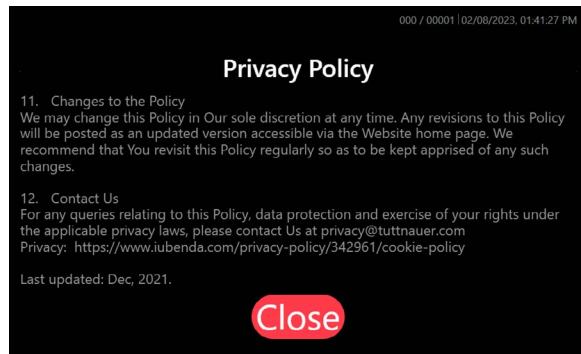
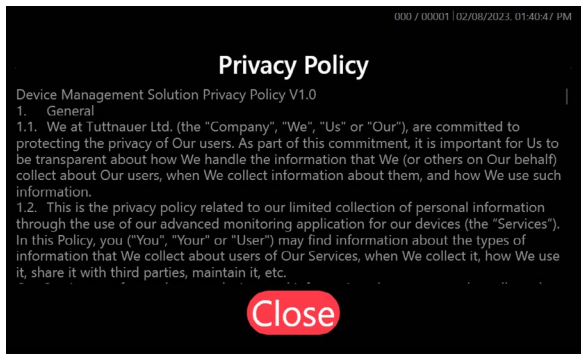

5. Press **Connect**.

6. The Wi-Fi is connected successfully. Press **Ok**.

USER INTERFACE

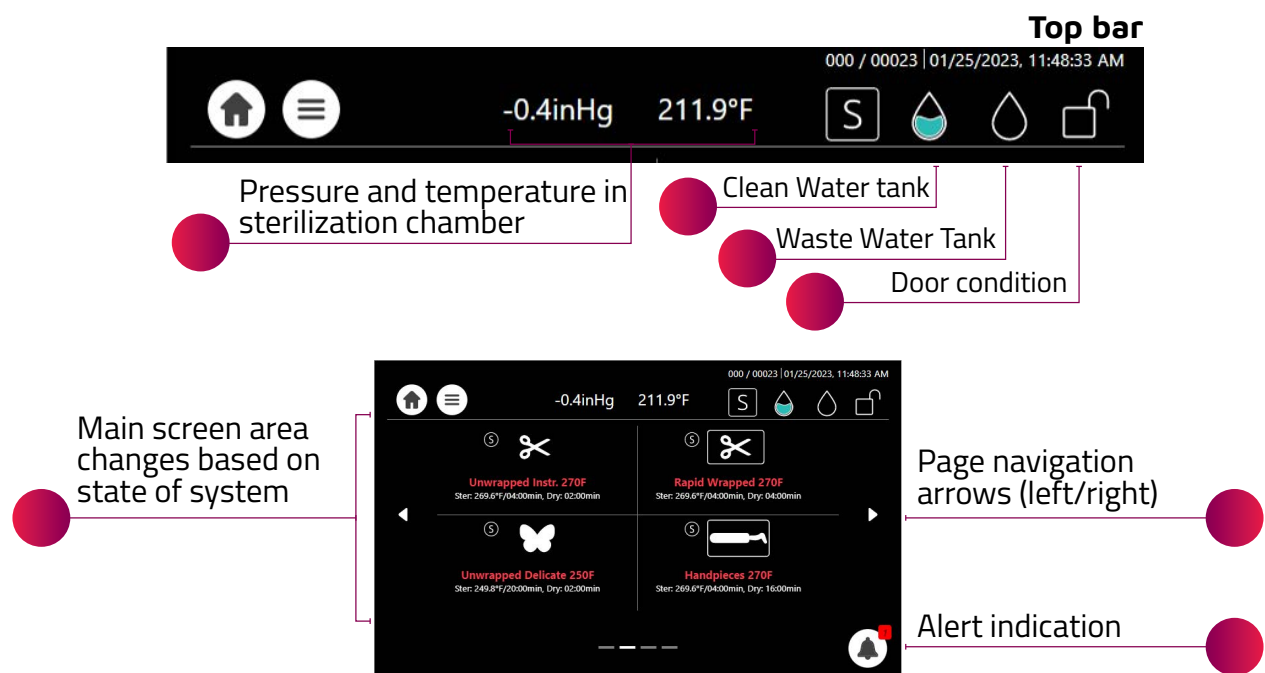

RESETTING ATMOSPHERIC PRESSURE

Prior to running the first cycle, resetting the atmospheric pressure is required.

To reset the atmospheric pressure, you must first open the Autoclave door and verify that the chamber's temperature is below 113°F.

1

Tap the Menu icon in order to get to the next screen with the WiFi icon

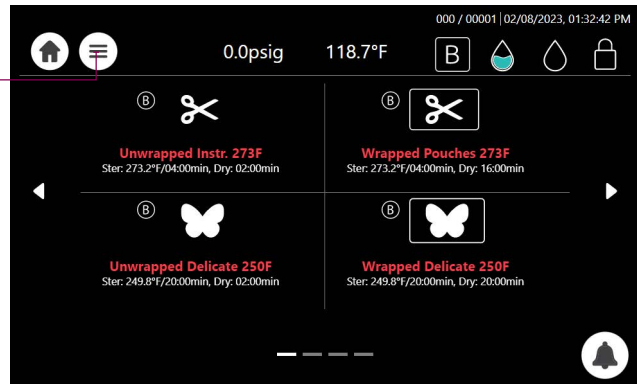

2

Tap the Settings icon and choose the Maintenance option

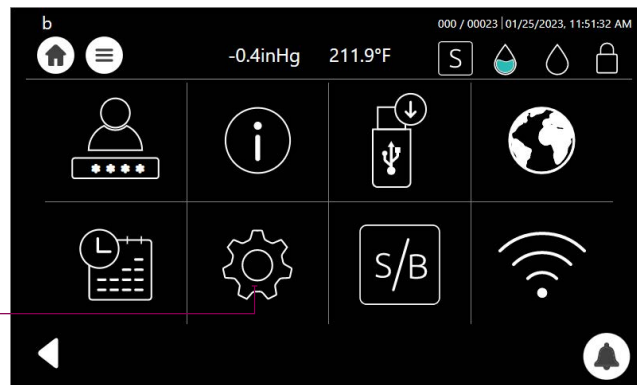

3

Tap on Reset atmospheric pressure

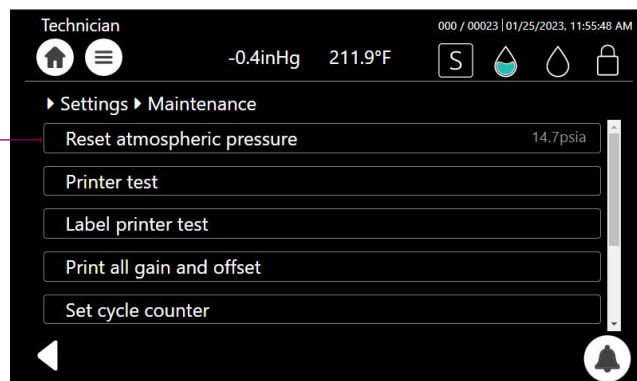

4

Tap on Reset

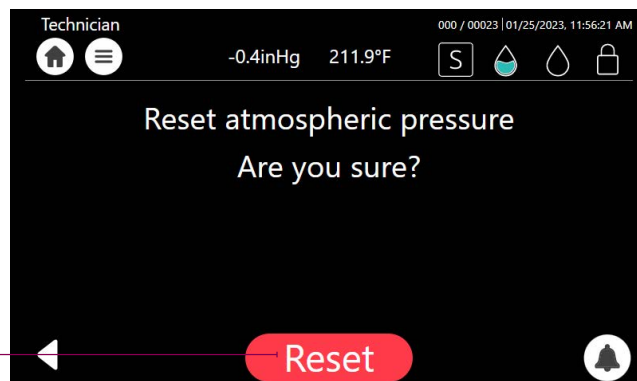

FILLING T-EDGE WITH WATER

Fill the water reservoir with distilled water as described below:

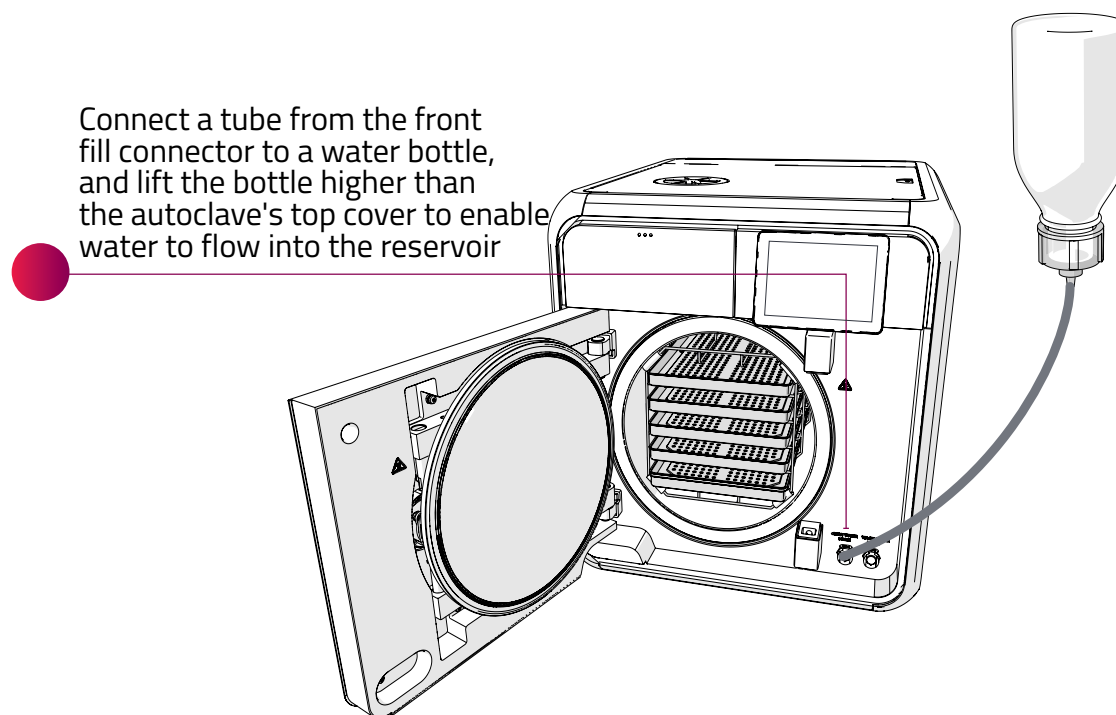
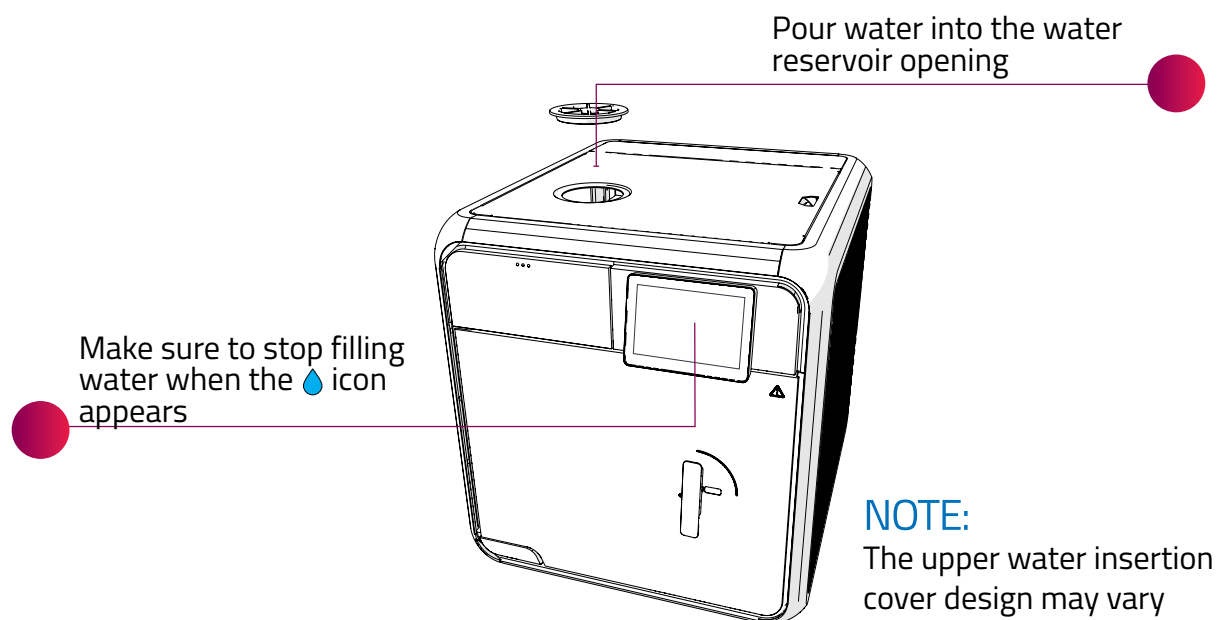

NOTE:

Use flexible soft bottles (do not use glass or rigid plastic bottles)

NOTE:

You may only fill T-Edge manually if it is not connected to the water supply facilities

LOADING EQUIPMENT INTO T-EDGE

Load equipment into T-Edge in one of the following ways:

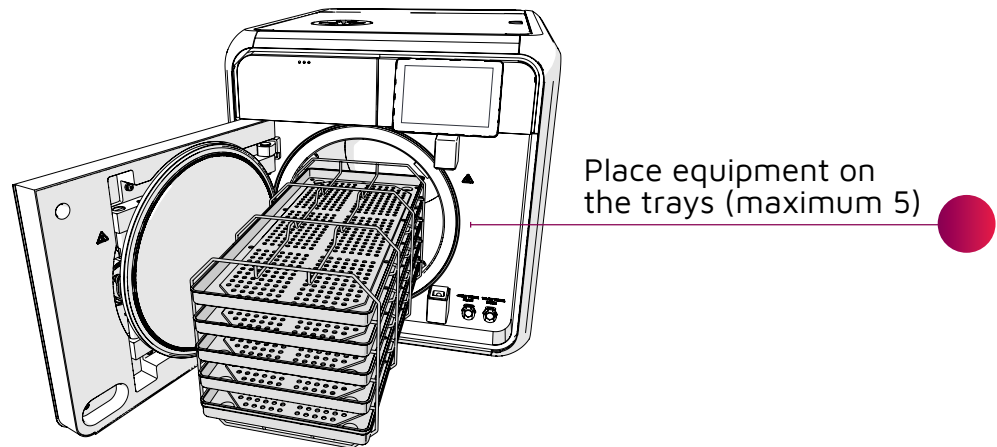

NOTE:

Equipment must be thoroughly cleaned prior to loading

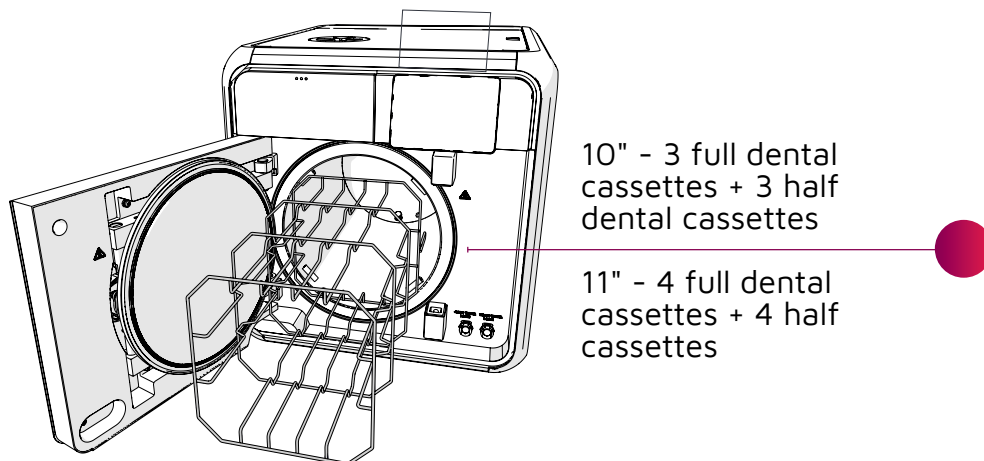

SELECTING STERILIZATION PROGRAM

- 1 Take note of the equipment in the chamber
- 2 Tap the relevant program on the screen

NOTE:

The door must be open in order to select a program

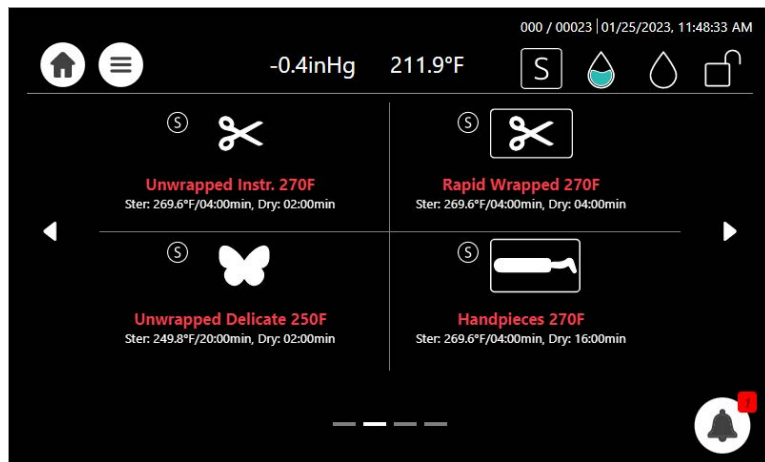

LOCKING THE DOOR

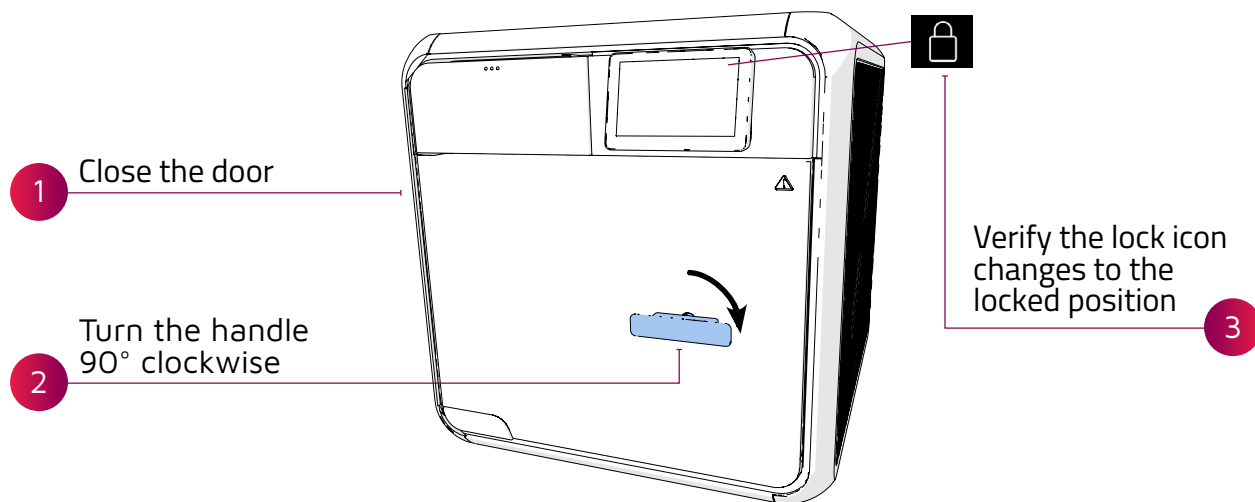

RUNNING STERILIZATION PROGRAM

1

Verify that the proper program has been selected

2

Tap Start

Tap to add extra drying time

Tap to apply virus protect stage

3

View status

Progress bar

If necessary, tap to stop sterilization process

REMOVING STERILIZED EQUIPMENT

When sterilization cycle is complete:

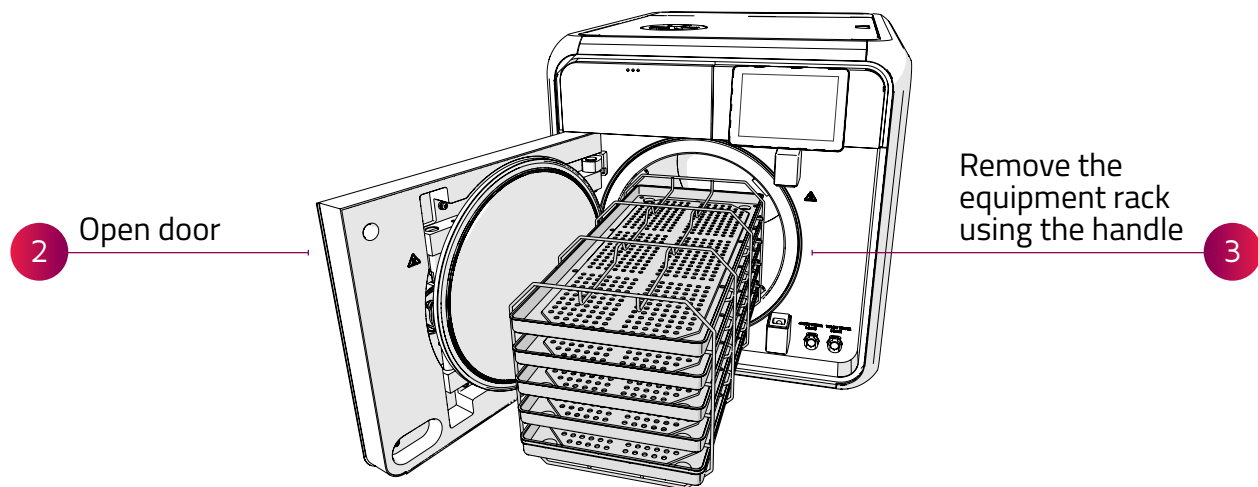
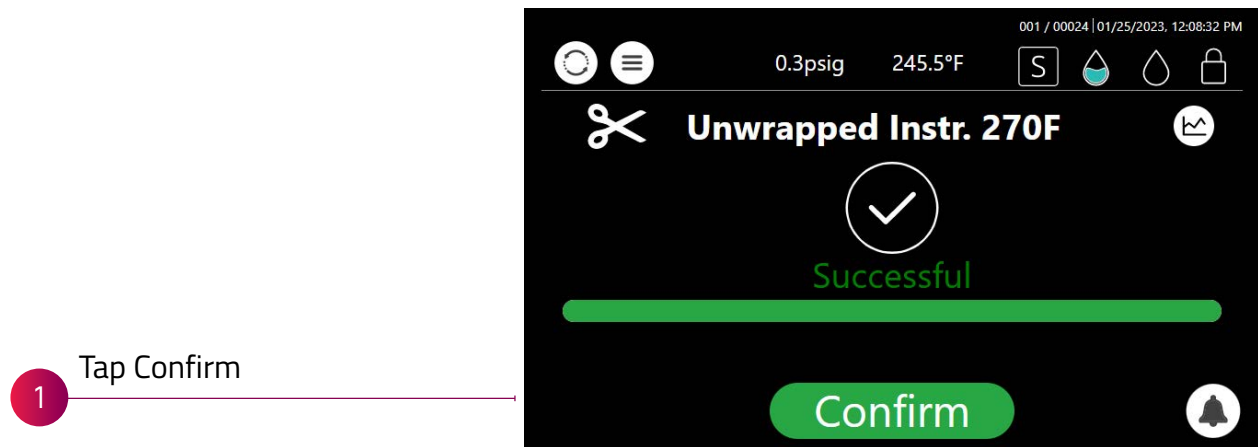







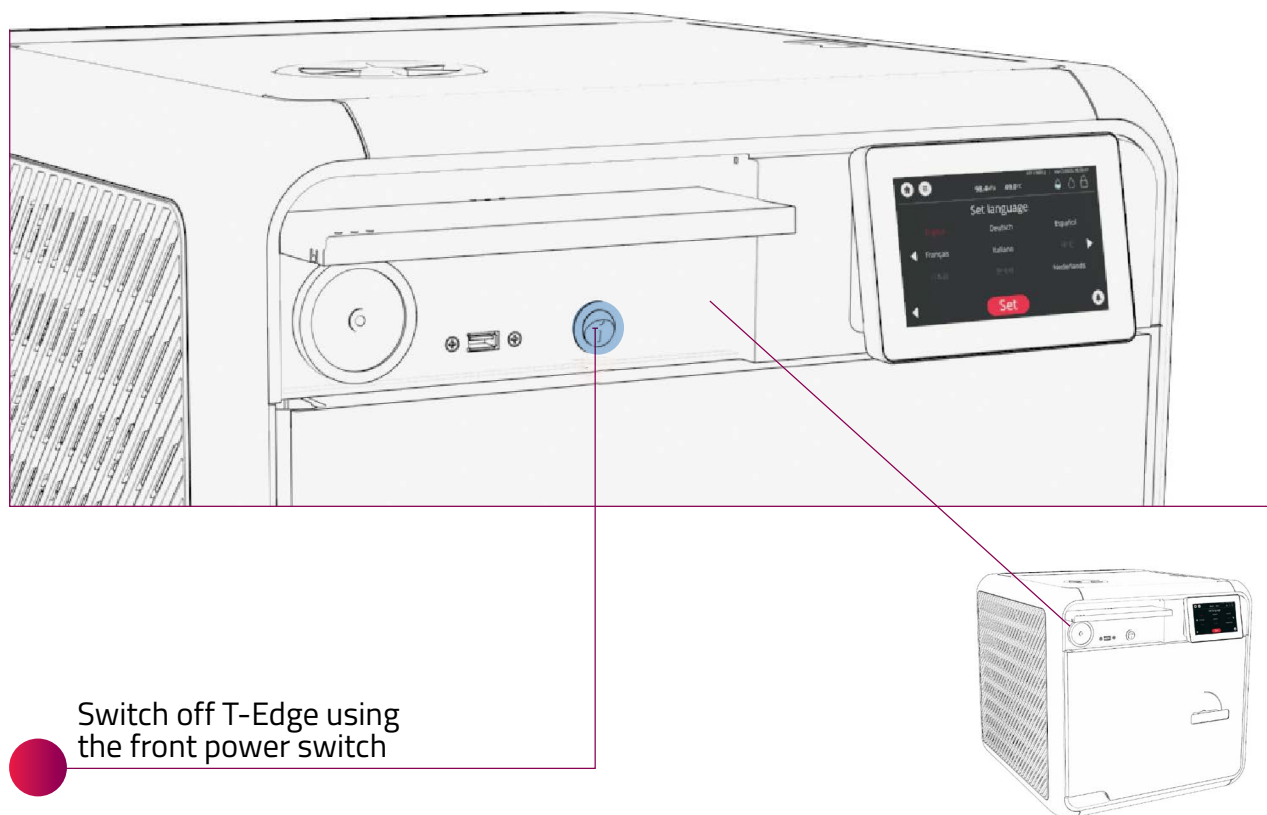

CAUTION!

Equipment rack is extremely hot
watch for vapor release when opening the chamber

TURNING OFF T-EDGE



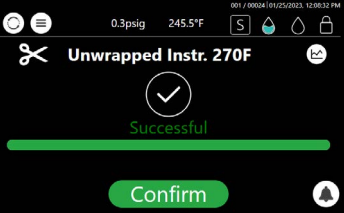
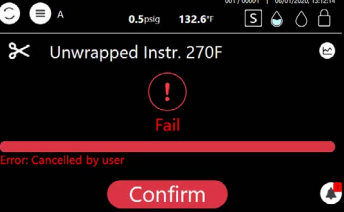







| Symbol / Message | Symbol / Message Description | Required Action (if applicable) |
|-------------------------------------------------------------------------------------|-------------------------------------------------------------------------------------------------------------------------------------------------------------------------------|--------------------------------------------------------------------------------------------|
|  | This symbol is displayed when the door is open. Note: The inherent safety feature of the machine enables the user to choose a cycle only when the door is open. | Informative symbol |
|  | This symbol is displayed when the door is closed. Note: The machine has an inherent safety feature that prevents the cycle from starting if the door is not closed. | Informative symbol |
|  | Full water level (Clean water tank) | Informative symbol |
|  | Low water level (Clean water tank) | Fill the mineral free water reservoir until this symbol changes to the proper level symbol |
|  | Proper water level (Clean water tank) | Informative symbol |
|  | Full water level (Waste water tank) | Empty the waste water reservoir |
|  | Good water level (Waste water tank) | Informative symbol |
|  | Alert | Press to watch the alert description |
|  | The "Successful" message and symbol are displayed when the cycle ends successfully. | |
|  | The "Fail" message and symbol are displayed when the cycle failed either due to intended cycle abort action by the user, or due to a run-time error. | Try performing a new cycle in order to sterilize the load. |

TECHNICAL SPECIFICATIONS

| Autoclave Model | Chamber Size (Inches) | Volume | Overall Dimensions D x W x H (Inches) | No. of Trays | Connections | Standard Cassette Capacity | Item Supplies | Voltage (V) Freq. (Hz) | Weight |
|-----------------|--------------------------|------------------|---------------------------------------|--------------|----------------------------------------------------------------------------------------------|----------------------------|-------------------------|------------------------|----------|
| T-Edge10 220V | 18" depth x 10" diameter | 6 gal/ 23 liters | 21.1"x19" x19.7" | 5 | 1 ethernet port, 2 USB ports, WiFi, intergrated automatic water filling and drain connection | 3 Full + 3 Half | Drain tube, tray holder | 230V, Frq 50-60Hz | 117 lbs. |
| T-Edge10 110V | 18" depth x 10" diameter | 6 gal/ 23 liters | 21.1"x19" x19.7" | 5 | 1 ethernet port, 2 USB ports, WiFi, intergrated automatic water filling and drain connection | 3 Full + 3 Half | Drain tube, tray holder | 120V, Frq 50-60Hz | 117 lbs. |
| T-Edge 11 220V | 18" depth x 11" diameter | 7 gal/ 27 liters | 21.1"x20" x19.7" | 5 | 1 ethernet port, 2 USB ports, WiFi, intergrated automatic water filling and drain connection | 4 Full + 4 Half | Drain tube, tray holder | 230V, Frq 50-60Hz | 124 lbs. |
| T-Edge11 110V | 18" depth x 11" diameter | 7 gal/ 27 liters | 21.1"x20" x19.7" | 5 | 1 ethernet port, 2 USB ports, WiFi, intergrated automatic water filling and drain connection | 4 Full + 4 Half | Drain tube, tray holder | 120V, Frq 50-60Hz | 124 lbs. |

STERILIZATION PROGRAMS

| | Icon | Cycle Program | Load Type | *T-Edge10 Cycle Times Including Drying (Minutes) | *T-Edge11 Cycle Times Including Drying (Minutes) |
|---------|-------------------------------------------------------------------------------------|---------------------------|--------------------------------|--------------------------------------------------|--------------------------------------------------|
| CLASS S |  | Unwrapped Instr. 270° F | Unwrapped Instruments | 20 Minutes | 25 Minutes |
| |  | Wrapped Pouches 270° F | Wrapped Pouches | 32 Minutes | 43 Minutes |
| |  | Unwrapped Delicate 250° F | Unwrapped Delicate Instruments | 45 Minutes | 47 Minutes |
| |  | Handpieces 270° F | Handpieces | 45 Minutes | 59 Minutes |
| | Icon | Cycle Program | Load Type | *T-Edge10 Cycle Times Including Drying (Minutes) | *T-Edge11 Cycle Times Including Drying (Minutes) |
| CLASS B |  | Unwrapped Instr. 273° F | Unwrapped Instruments | 20 Minutes | 26 Minutes |
| |  | Wrapped Pouches 273° F | Wrapped Pouches | 39 Minutes | 49 Minutes |
| |  | Unwrapped Delicate 250° F | Unwrapped Delicate Instruments | 35 Minutes | 35 Minutes |
| |  | Wrapped Delicate 250° F | Wrapped Delicate Instruments | 58 Minutes | 75 Minutes |

*Cycle times are approximate and may vary based on the instrument load, heating, sterilization and drying and wall voltage.